

BeHear®
ACCESS

HearLink®
PLUS

BUNDLE

Quick Start Guide



For more information
visit our Web site
www.WearAndHear.com

Wear & Hear

1 Setting Up BeHear ACCESS

Connect the charging cradle to a power source (computer USB port or wall socket using adaptor, purchased separately) and place the headset in the cradle.

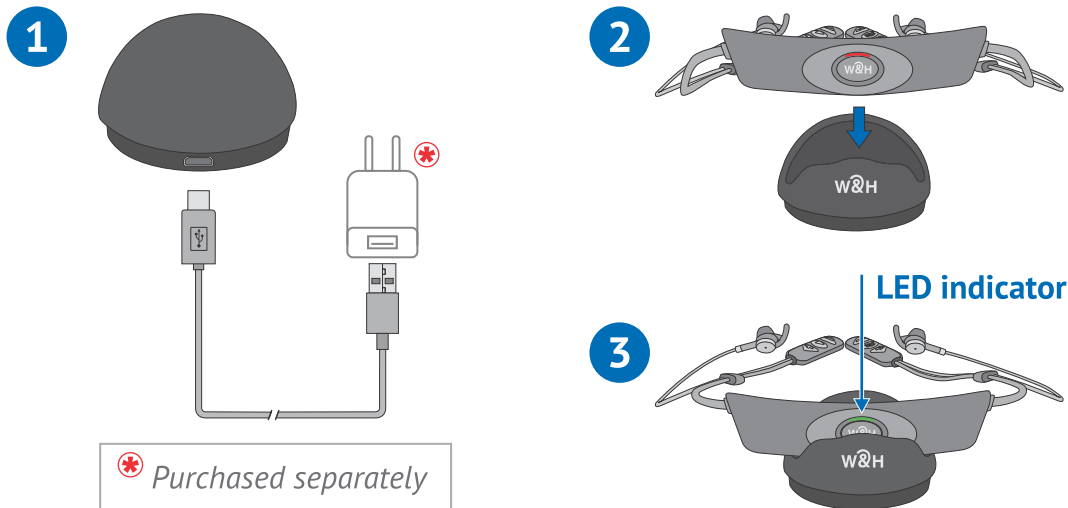

The LED indicator on the headset is red during charging and turns green when the headset is fully charged.



Before the first use, charge the battery up to 3 hours until the LED indicator turns green.

To turn BeHear ACCESS "ON" press and hold the power button approximately 3 seconds until the unit vibrates and the LED turns light blue.

To turn BeHear ACCESS "OFF" press and hold the power button approximately 3 seconds until the unit vibrates and the light blue LED turns off.

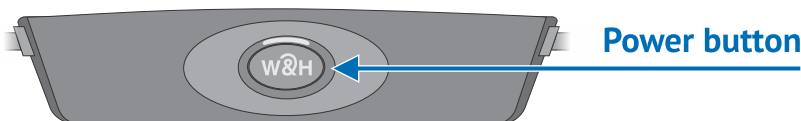

2 Setting Up HearLink PLUS

1. Connect HearLink PLUS to a power outlet (A) or the TV set's USB port (B) using the supplied USB power cable. HearLink PLUS will turn ON automatically.

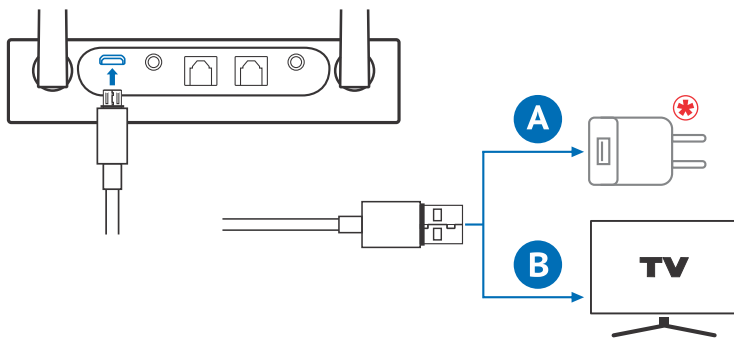

2. Set the Mode switch to the **TX** position.

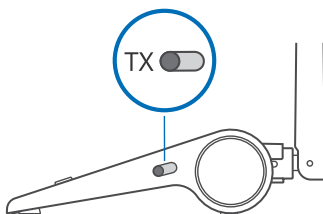

3. Connect the HearLink PLUS TX port to the TV (or other media device) via the supplied optical or 3.5mm audio cable. The active connection type is indicated by the illuminated text (**OPT** or **AUX**) on the HearLink PLUS front display panel.

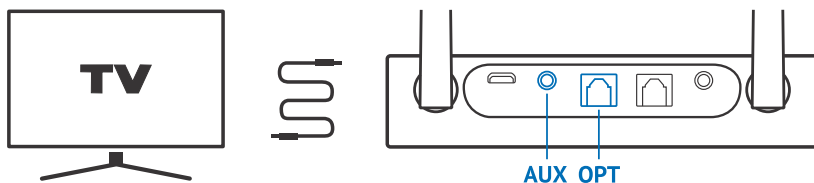

Make sure to remove the plastic protectors from the optical cable terminals prior to insertion.

3 First Time Connection

1. Place **HearLink PLUS** into pairing mode with a short press on its  button.

When in pairing mode the **TX** indicator light will flash quickly.

2. If **BeHear ACCESS** is ON, press the Power button  until the LED switches OFF.

Press the Power button  for about 5 seconds until the LED flashes red/blue.

3. Place the BeHear ACCESS headset close to the HearLink PLUS device.

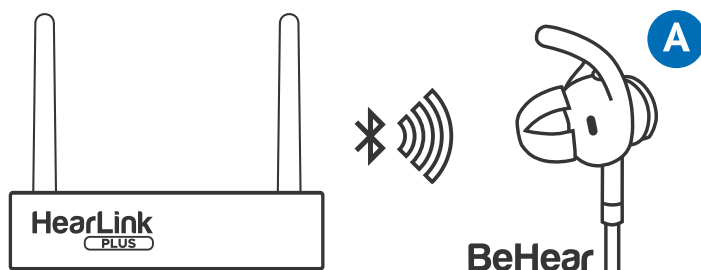

4. When pairing is complete (after 5-30 seconds) **TX** will be illuminated on the HearLink PLUS front display panel.

The **LL** is illuminated to indicate that the Low Latency APTX-LL Bluetooth CODEC is being used.

Successful connection of the BeHear ACCESS headset is indicated by the illuminated **A** on the HearLink PLUS front display panel.

4

Audio Playback

1. HearLink PLUS Manual Control



Short press to toggle audio **Play/Pause**.



Press to **increase** the volume. A tone is played when maximum volume is reached.



Press to **decrease** the volume. A tone is played when minimum volume is reached.

2. BeHear ACCESS Remote Control

Manage audio play using the headset's left-hand controls.



Short press to toggle **Play/Pause** audio.



Press to **increase** the volume.







Press to **decrease** the volume.



Short press both buttons simultaneously to toggle between two connected audio sources (e.g., HearLink PLUS and a smartphone).

5 Helpful Information

1. If you do not hear audio:
 - Ensure that the 'audio out' port of your TV (or other media device) connected to the HearLink PLUS is active. For some devices you need to enable the audio output. Refer to your device's user manual.
 - Toggle the Play/Pause  button on the BeHear headset or  button on the HearLink PLUS.
 - Toggle between the connected audio sources with simultaneous short presses on the BeHear headset's  and  buttons.
2. If the automatic connection is delayed, a short press on the BeHear ACCESS headset's Power button  will reconnect it to a previously paired HearLink PLUS transmitter and/or smartphone.
3. Use the HearLink PLUS **Bypass** mode to maintain the existing interfaces between your TV and peripheral audio equipment.

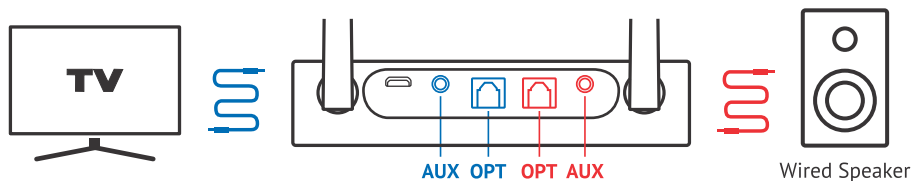

Connect the HearLink PLUS **TX** port to the TV via the optical or 3.5mm audio cable, and the **RX** port to a speaker or other peripheral audio equipment using the same type of cable as the TX port connection.

To passthrough HearLink PLUS set its Mode switch to **Bypass** position, indicated by . To restore connection with the BeHear ACCESS headset set the Mode switch to **TX**.